

POE keiga

Audio Amplifiers

PoE / PoE+ / PoE++ • IEEE802.3at / af / bt • Up to 71W

25 Years of *Reliability*



AUDIO AMPLIFIER & IoT DEVICE JDM / ODM / OEM
SOFTWARE / HARDWARE / MANUFACTURING

Confidential © 2021 KEIGA ELECTRONIC INC. v.6



Power Over Ethernet

POE

The Future Is Now...

Market Studies are on
PoE Products in general

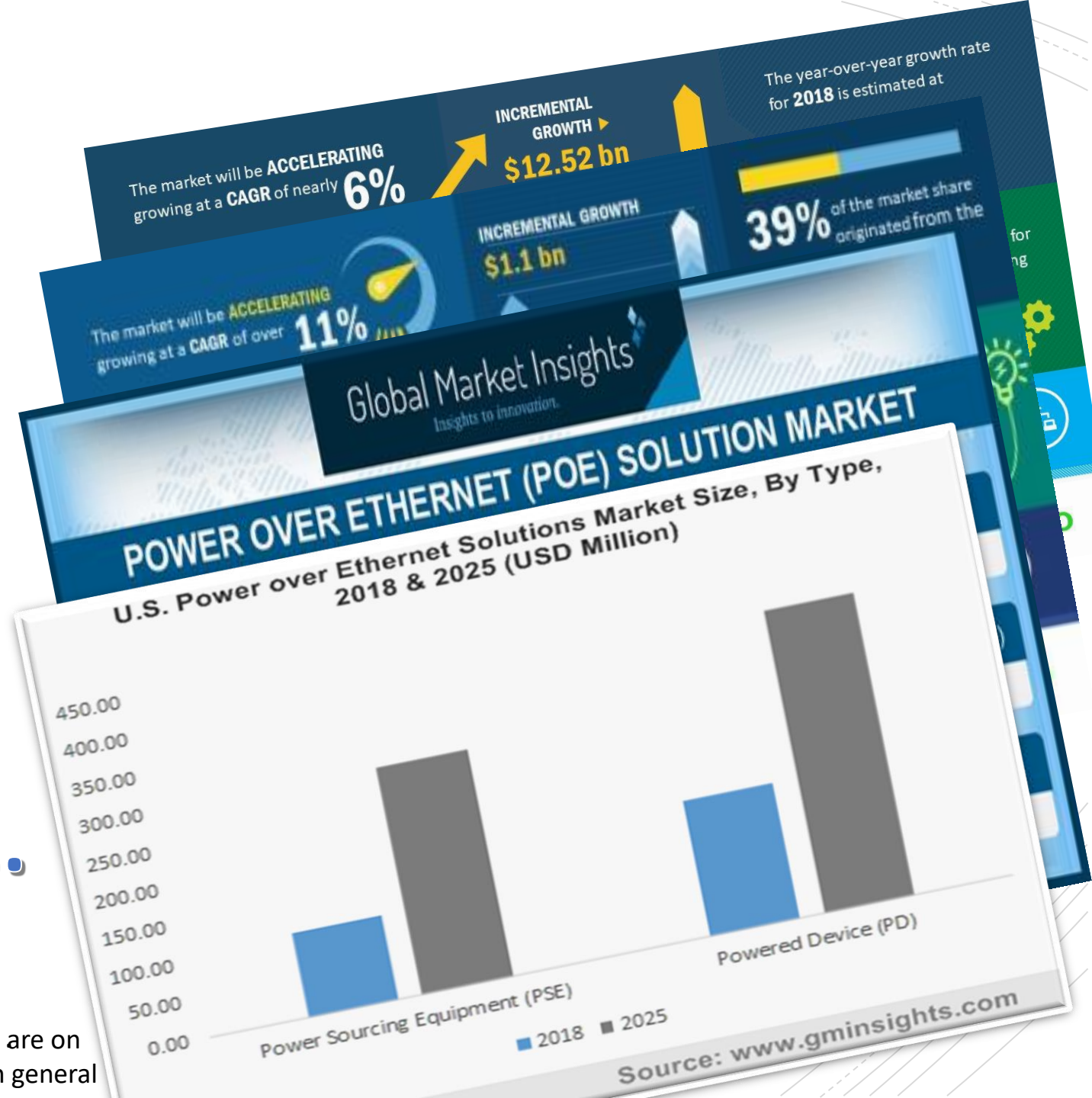

The Future Is Now...

**IEEE Standard 30W, 60W
and 90W PSE** (Power Source
Equipment) **are Available Now!**

**Audio Amps become IoT
Addressable Devices!**

**PoE Audio is the Profit
Generator Today!**

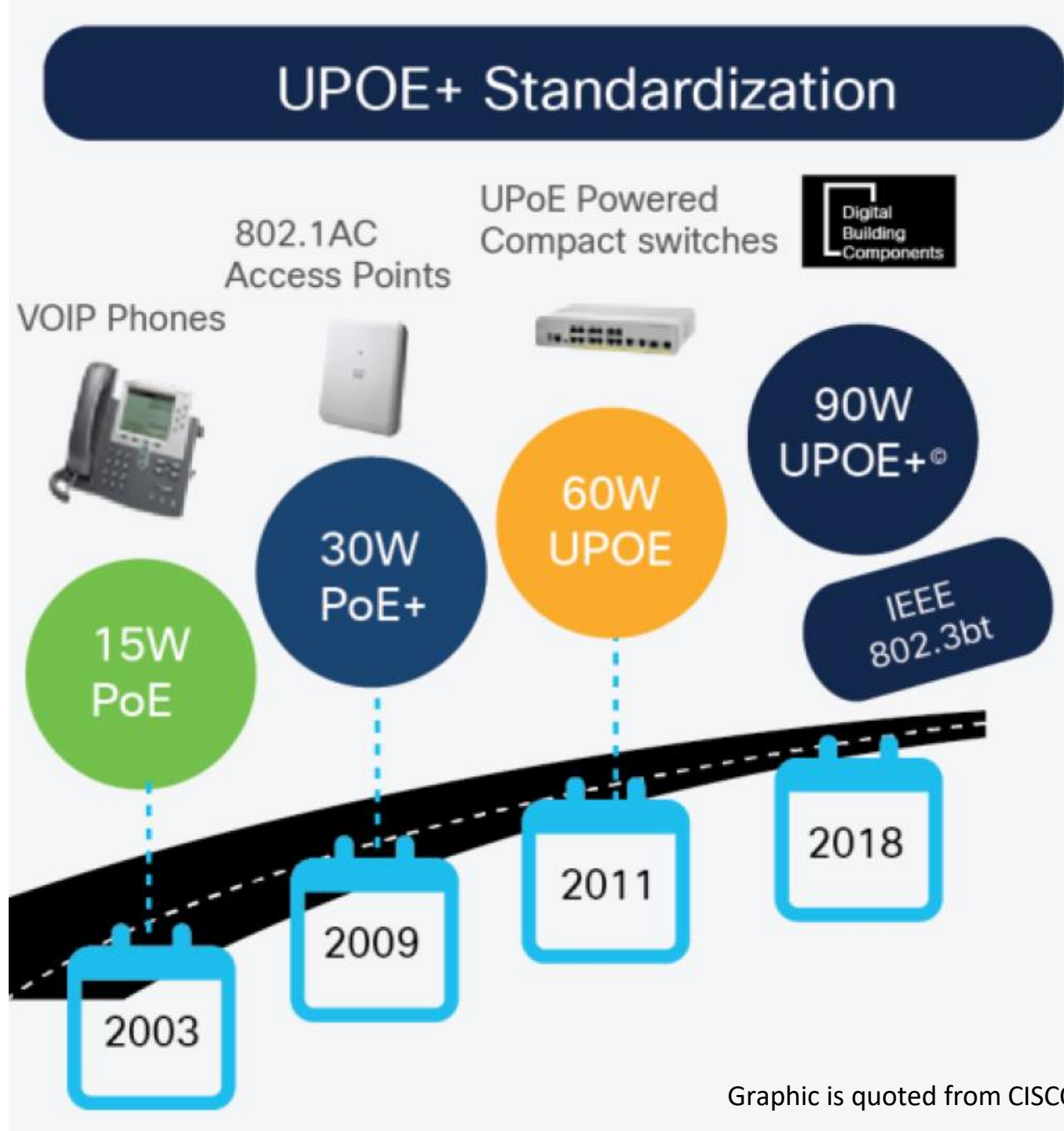



Standards up to 71W (PoE++ / IEEE802.3bt)

IEEE Standards	802.3af Type 1 PoE	802.3at Type 2 PoE+	802.3bt Type 3 PoE++	802.3bt Type 4 PoE++
PD Rated Power	12.95W	25.50W	51W	71W
PSE Max. Power	15.4W	30W	60W	100W
PSE Voltages	44 to 57V	50 to 57V		
PD Voltages	37 to 57V	42.5 to 57V		41.1 to 57V
Max. Current	350 mA	600 mA	600 mA per pair	960 mA per pair
Cable Supported	CAT3 and CAT5	CAT5		

PD (Powered Device, e.g., Audio **Amplifiers**)

PSE (Power Sourcing Equipment, e.g., **Network PoE Switches**)

The Future Is Now...

Every **IoT** device can be **remotely** centralized, controlled and managed.

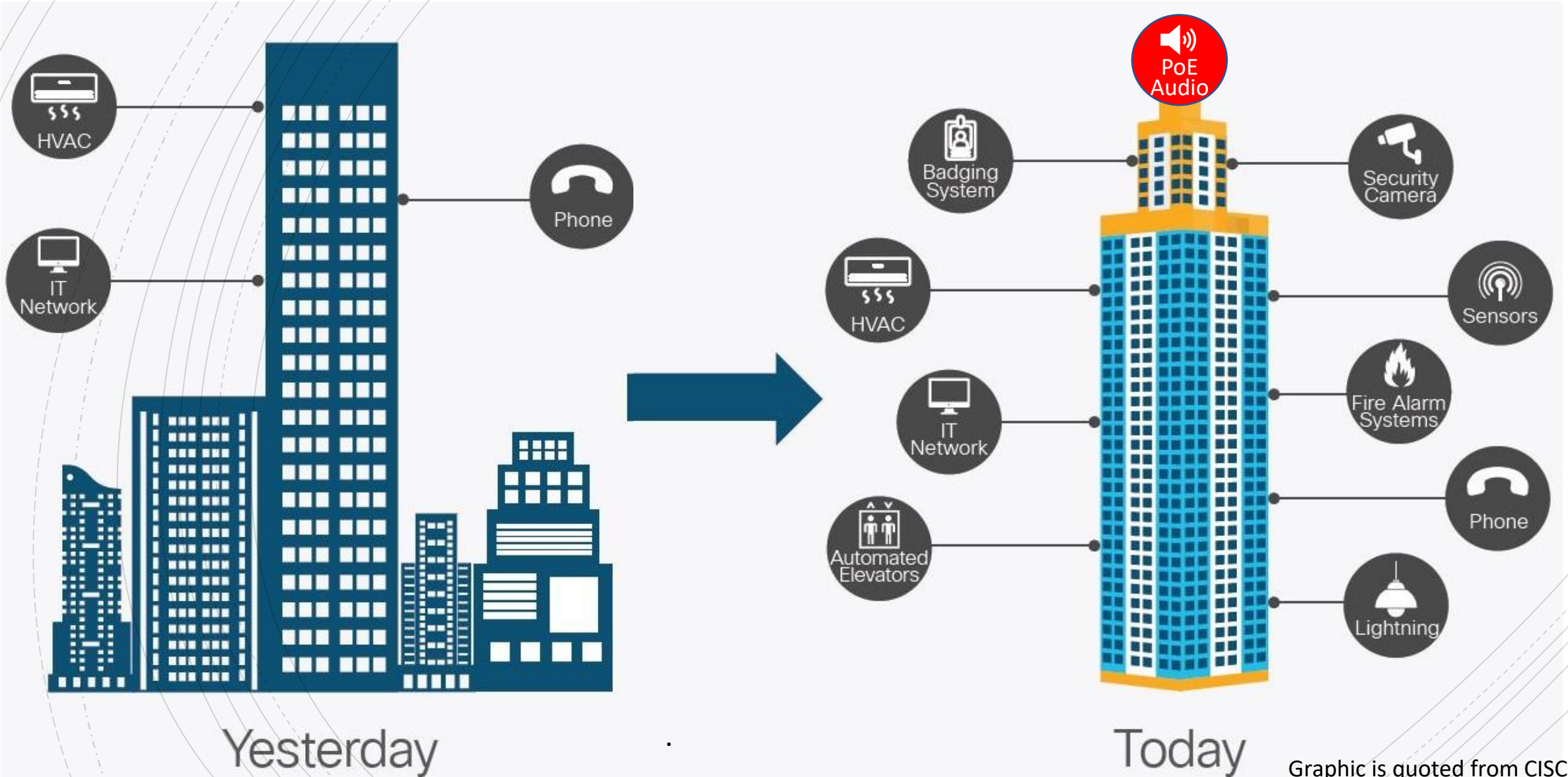



A **Keiga** DSP Amplifier

can drive **multiple speakers**

to deliver up to **71W** of sound

via one Ethernet cable, **no power cable,**

and each amplifier can be **remotely**

addressable, discoverable, profileable and controllable.

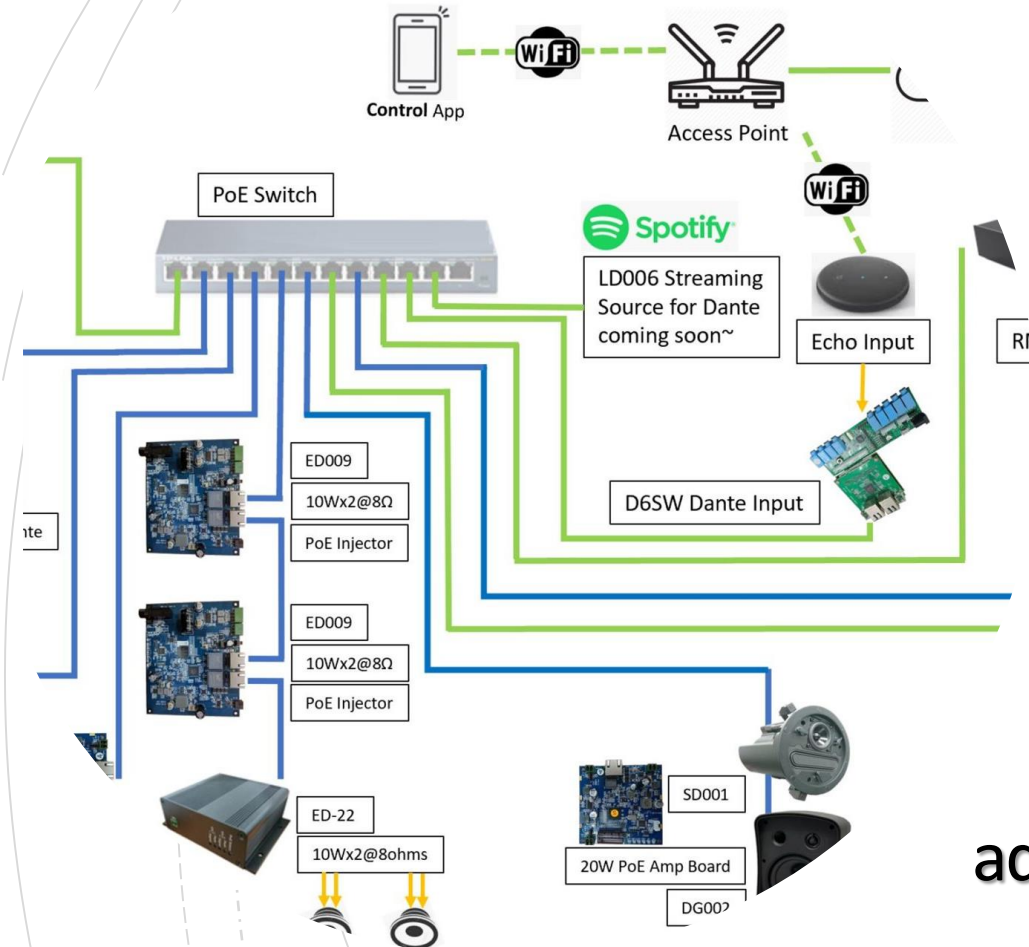

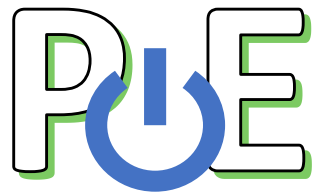

Amplifier Experience

- In 2017 CEDIA launched the industry's first **Amazon Echo Dot Distribution Amp*** via Keiga's proprietary balun over Cat5 cable to deliver both power and audio signals
- In 2018 CEDIA exhibited the industry's first **Amazon Echo Dot In-Wall 60-Watt Amp***
- In 2019 ISE announced the Industry's first IEEE standard **PoE++ built-in 60/100-Watt Ceiling Speaker***
- In 2020 released a line of IEEE standard **2ch and 4ch PoE/PoE+/PoE++ DSP Amplifiers**

*Products developed by Keiga for various 3rd parties.



Power Over Ethernet

PoE

Product Lines >>>

Hardware

Software

Ecosystem

Commercial

Residential

Awaiting Your
Customization

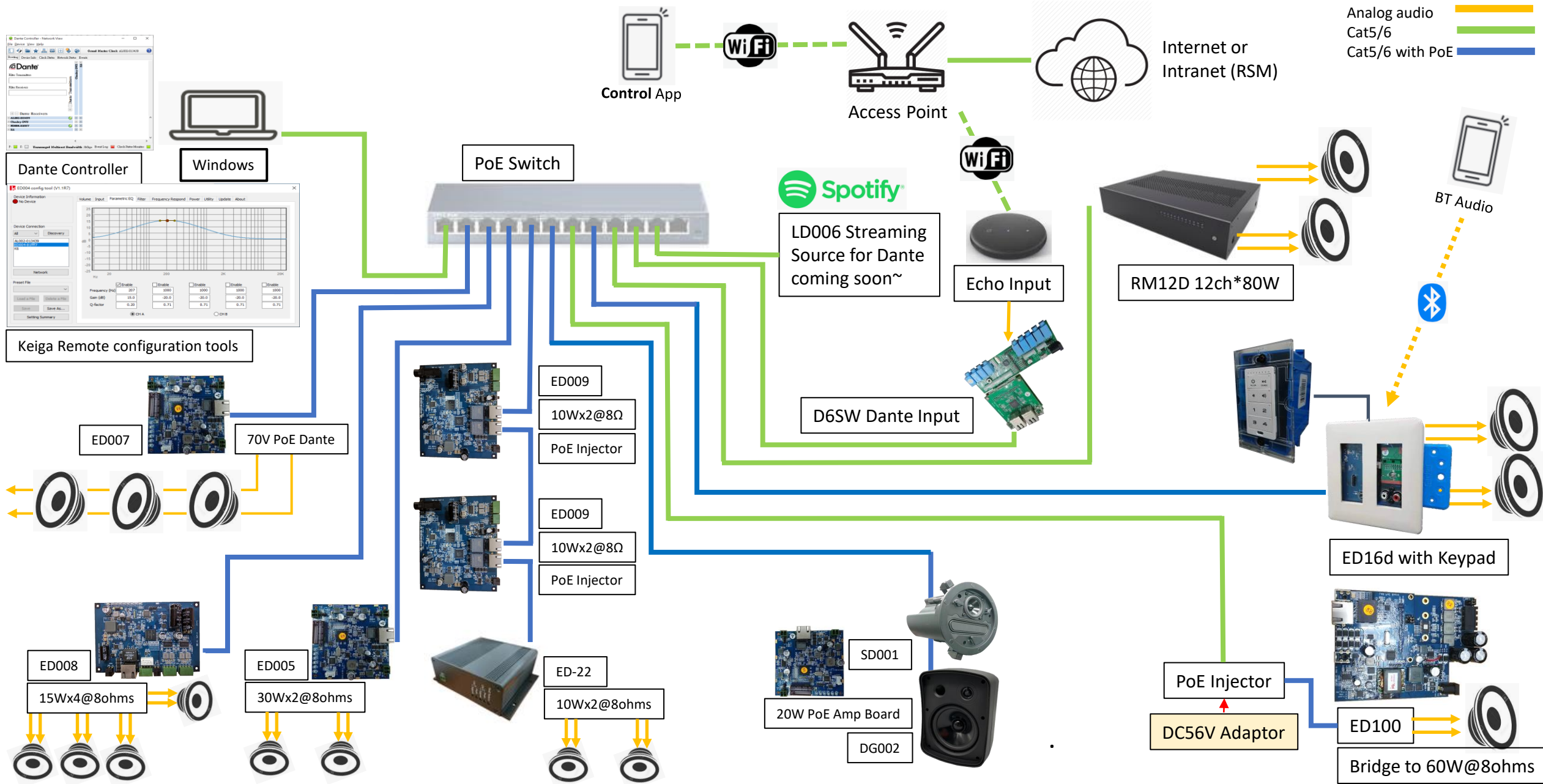

Keiga Dante PoE Commercial PA Applications

Analog audio 
Cat5/6 
Cat5/6 with PoE 

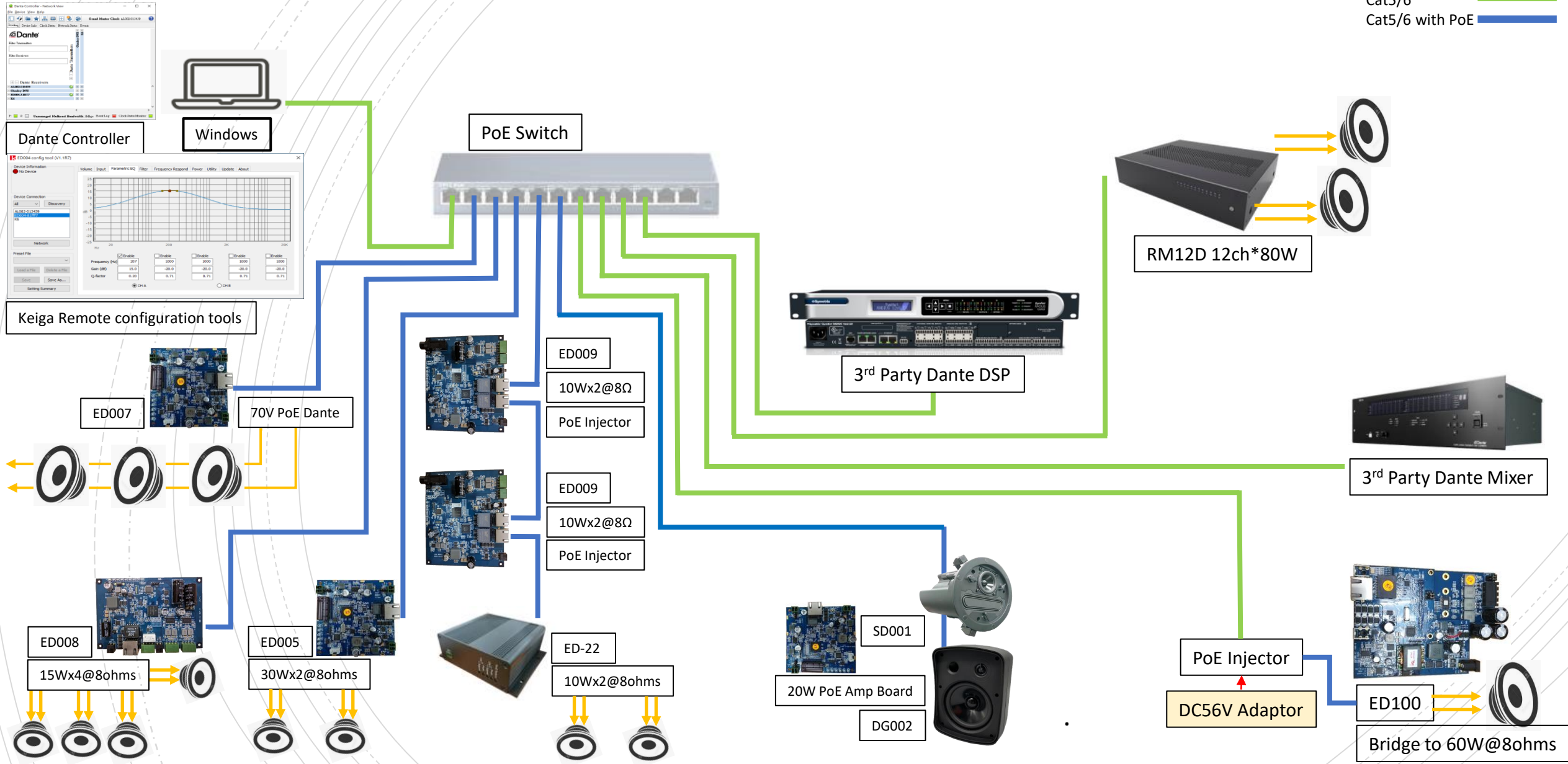

Keiga Dante PoE Residential Applications

Keiga AMOR™
Volume and Mute control
by Group or Each
Assign music from LD006U



Access Point



Internet or
Intranet (RSM)

Analog audio 
Cat5/6 
Cat5/6 with PoE 

ED-22U
10Wx2@8ohms



Passive Speaker

ED-71U
30Wx2@8ohms



Passive Speaker

DG002U
20W@4ohms



SD001U
20W@4ohms



PoE Switch



LD006U Streaming
Source for Dante
Coming soon~



Passive Speaker



*Contact Us
for the
Details of
all These
Applications* 

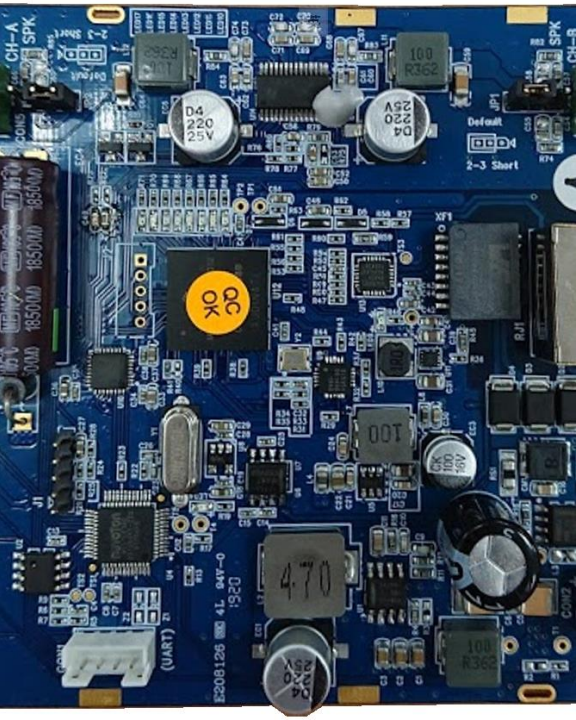

PoE Amps in Two Formats

An **End Device**
to be installed
near your regular speakers.

or

A **Board**
to be customized
into your speaker housing
to become your own
PoE Ready speaker



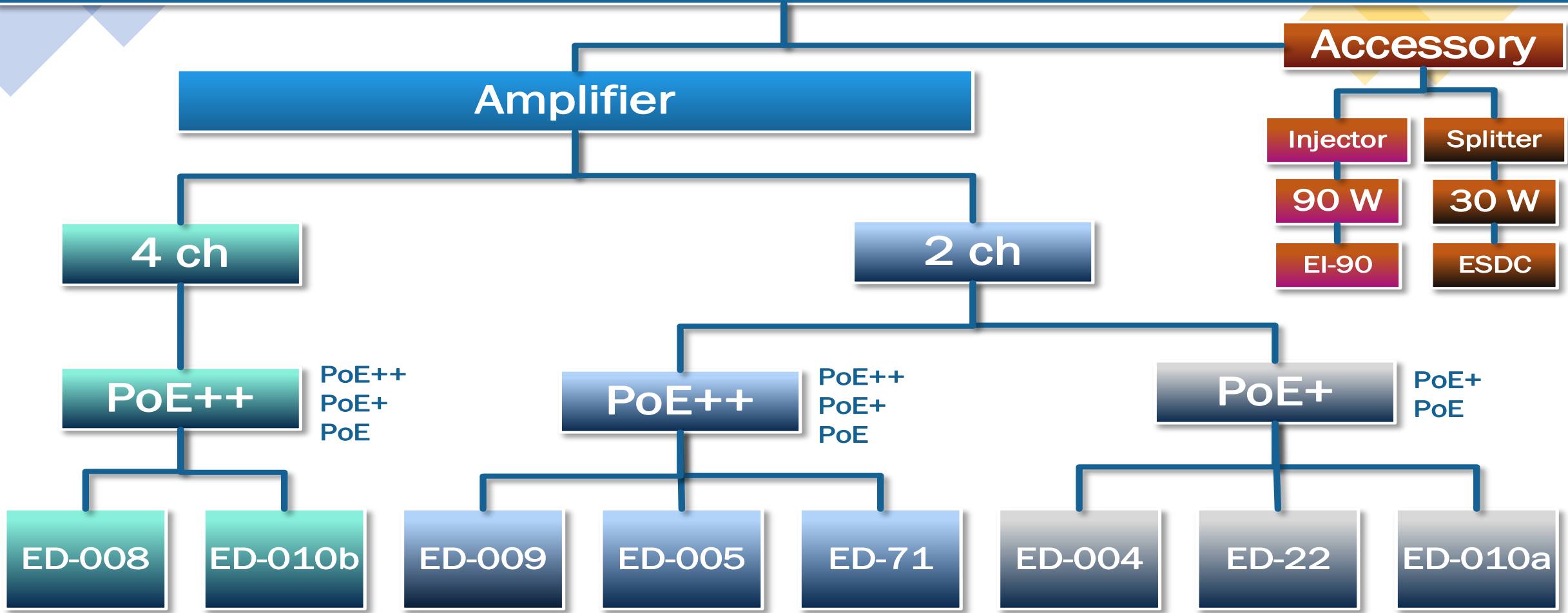

To Be Released
Q2, 2021



To Be Released
Q2, 2021

Model	ED-008	ED-010 b
PoE Chip	TI: PoE++, PoE+, PoE	
Audio Chip	Dante Ultimo	
Max. Power	PD: 71W	
KAP DSP	Yes	No
FQ Response	20Hz - 20KHz	
Signal Ratio	> 90dB	
FIND ME	Yes	No
Specials	GPIOx2	
Audio Amp RMS	15Wx4@8Ω 30Wx2@8Ω	
Audio Network	Dante/AES67	
Compliance	IEEE802.3at/af/bt	
Protection	OCP, OTP, OVP Auto Recovery Surge Protection	
DC Power	DC48V/1.6A, Optional	



4ch PoE++

ED-008

ED-010 b

To Be Released
Q2, 2021

Model	ED-009	ED-71 / ED-005
PoE Chip	TI: PoE++, PoE+, PoE	
Audio Chip	Dante Ultimo	
Max. Power	PD: 71W; PSE: 90W	PD: 71W
KAP DSP	Yes	
FQ Response	20Hz - 20KHz	
Signal Ratio	> 90dB	
FIND ME	Yes	
Specials	MIC In/Line In PoE+ Daisy Chain	
Audio Amp RMS	10Wx2@8Ω 20W@4Ω PoE+ Extension w/o DC	35Wx2@8Ω 70W@4Ω
Audio Network	Dante/AES67	
Compliance	IEEE802.3at/af/bt	
Protection	OCP, OTP, OVP, Auto Recovery, Surge Protection	
DC Power	DC48V/1.6A, Optional	

2ch PoE++

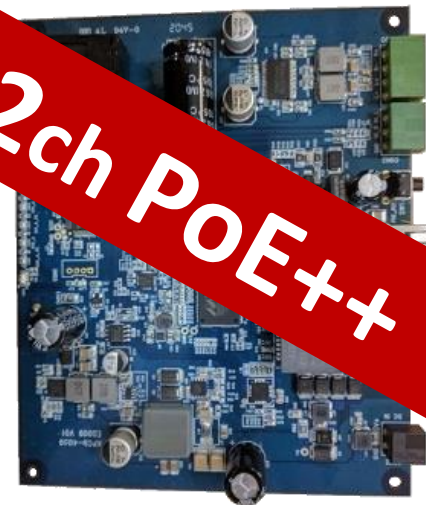

ED-009

ED-071



ED-005

Model	ED-22 / ED-004	ED-010 a
PoE Chip	TI: PoE+, PoE	
Audio Chip	Dante Ultimo	
Max. Power	PD: 22W	
KAP DSP	Yes	No
FQ Response	20Hz - 20KHz	
Signal Ratio	> 90dB	
FIND ME	Yes	No
Audio Amp RMS	10Wx2@8Ω 20W@4Ω	
Audio Network	Dante/AES67	
Compliance	IEEE802.3at, IEEE802.3af	
Protection	OCP, OTP, OVP, Auto Recovery Surge Protection	
DC Power	DC24V/2.5A, Optional	

ED-022

ED-004

To Be Released
Q2, 2021

ED-010 a

Model	EI-90	ESDC
PoE Chip	LTC: PoE++	TI: PoE+, PoE
Audio Chip	N/A	
Max. Power	PSE: 90W	PD: 30W
KAP DSP	N/A	
FQ Response	N/A	
Signal Ratio	N/A	
FIND ME	N/A	
Product Type	PoE Injector	PoE Splitter for DC5/12V
Audio Network	N/A	
Compliance	IEEE802.3bt	IEEE802.3at / af
Protection	SCP, OTP Surge Protection	OTP, OVP, OCP, SCP, Surge Protection
DC Power	DC56V/2A, Optional	DC5V/12V Output

Injector & Splitter

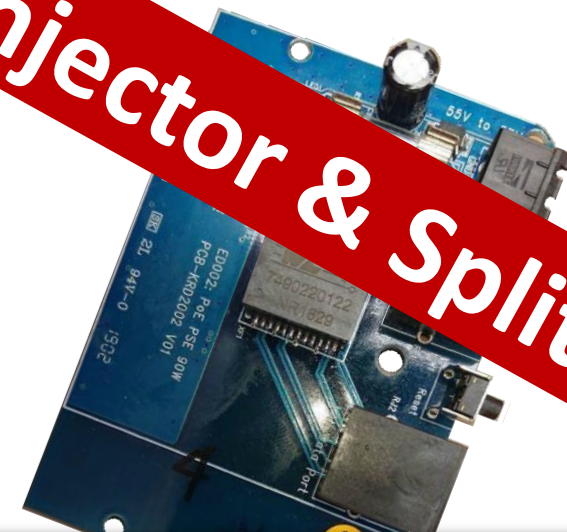

***All Boards can
be Customized
to Your Own
Shapes and
Sizes.***



Power Over Ethernet

Exclusive

DSP Configuration Software

POE KAAPTM

KEIGA

AUDIO

PERFORMANCE

- Auto **discovers** Dante devices and saves speaker **profiles**
- Input **Sensitivity** Selection to match **full-scale RMS**
- Input **Limit** configuration to **avoid input clipping**
- Output **Volume** to adjust and mute output

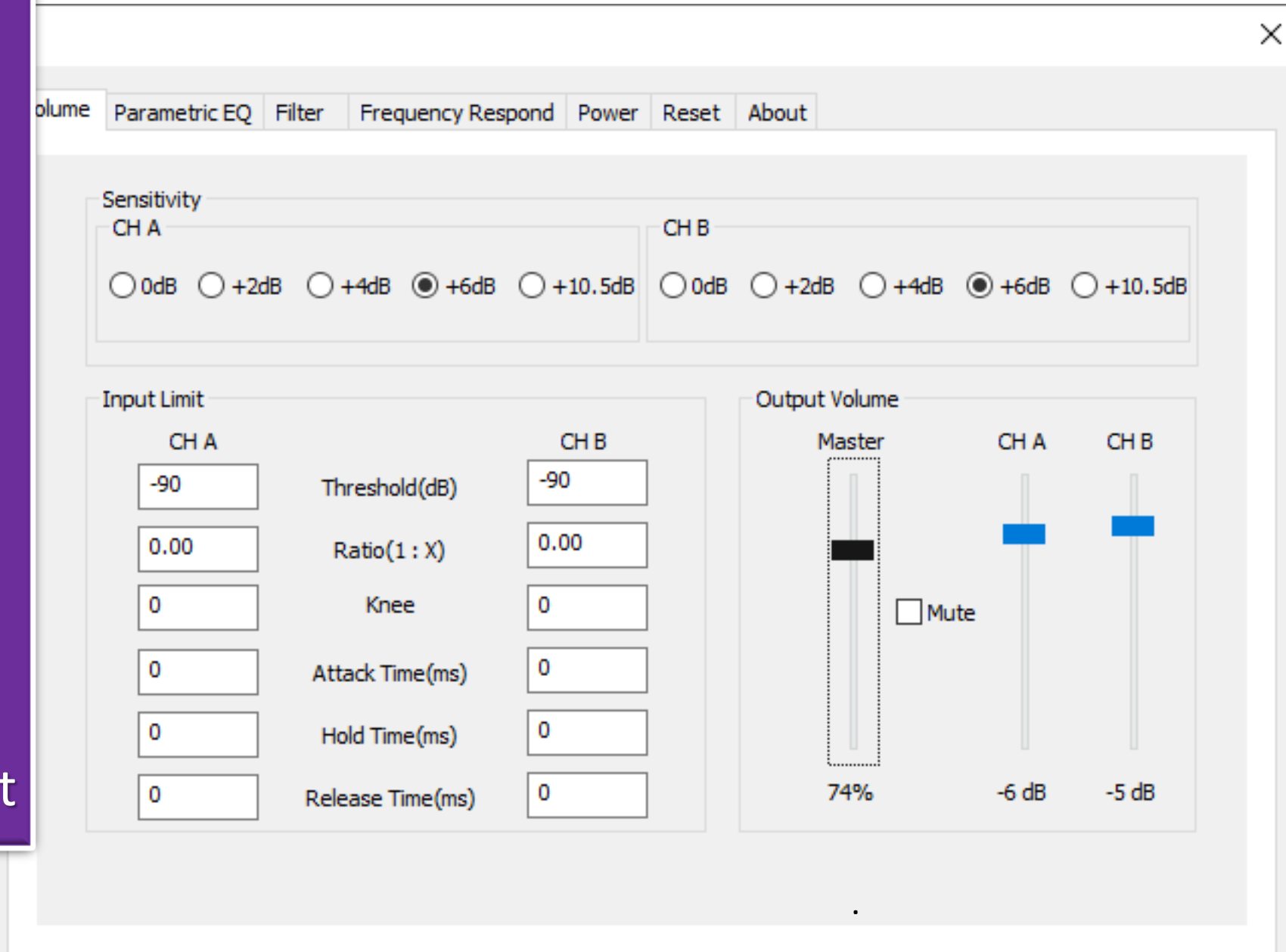

- Up to 5 sets of PEQ for each Ch A and Ch B
- Uses number key to input values or mouse to move the curve to match speaker's characteristics

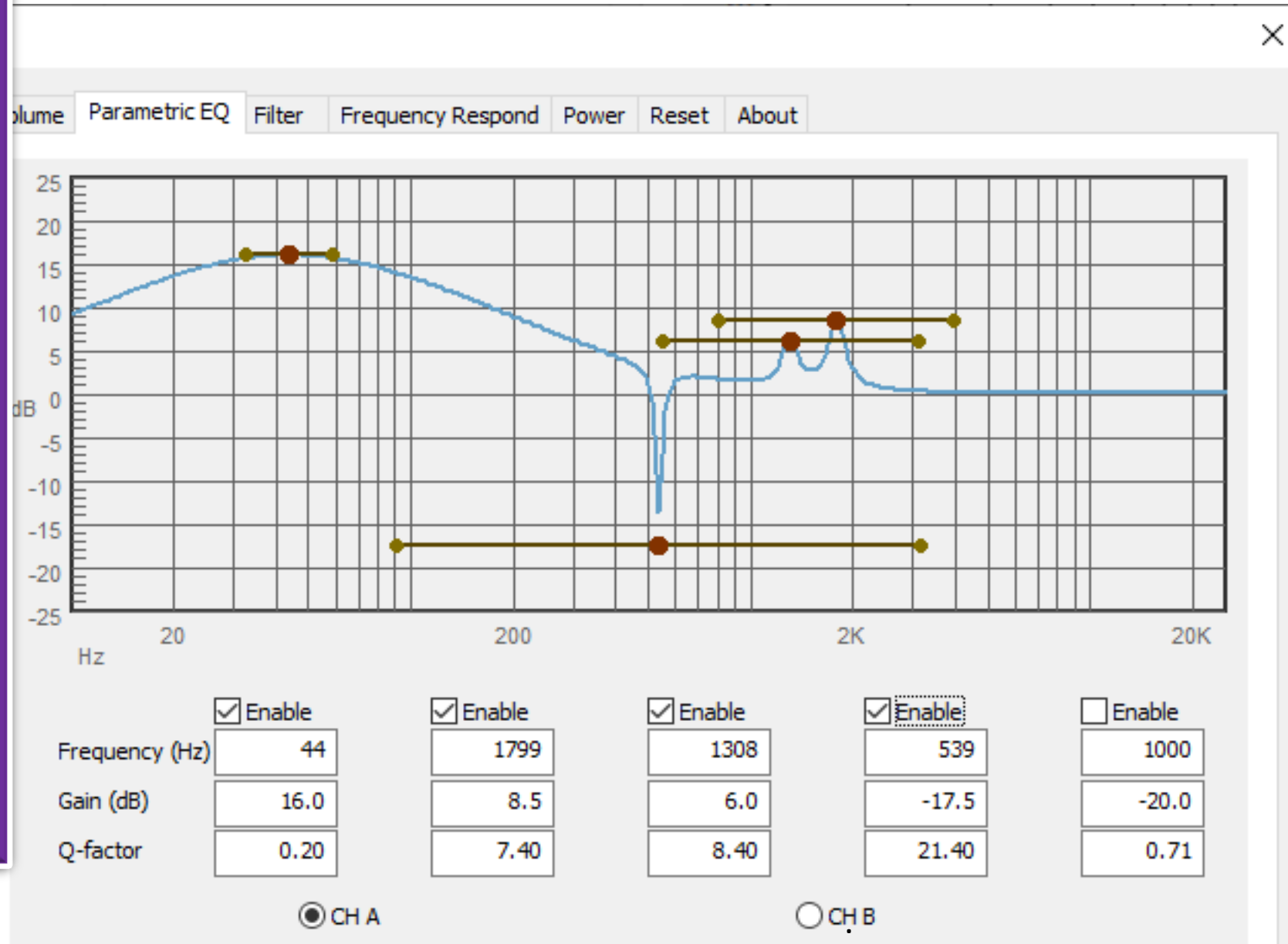

- **High-pass filter** and **Low-pass filter** to match the speaker specifications
- Supports **stereo** or **two-way** speaker configuration

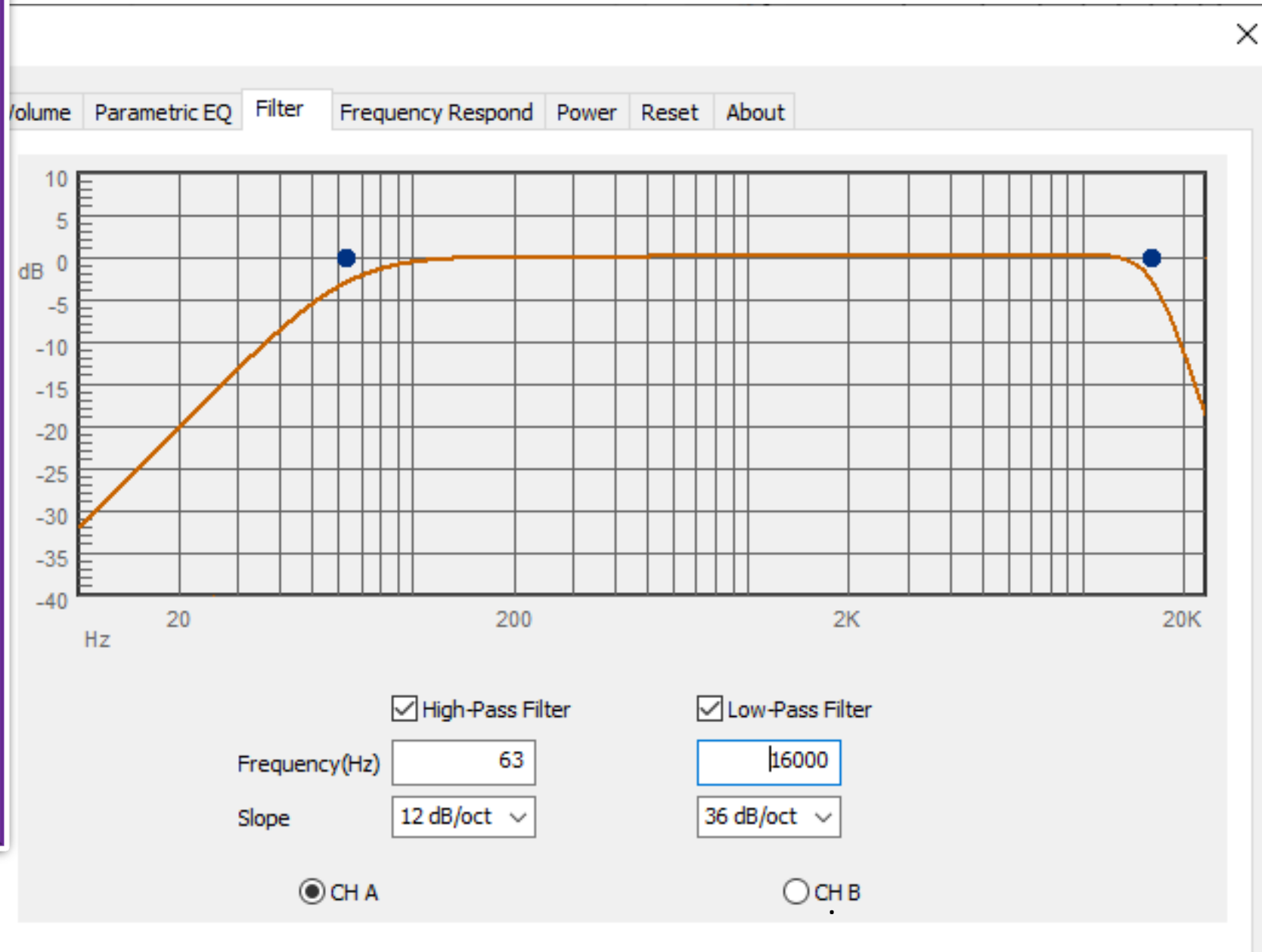

- Summary of a frequency response emulation; **easy** for installers to have a view of the whole scope of the configuration

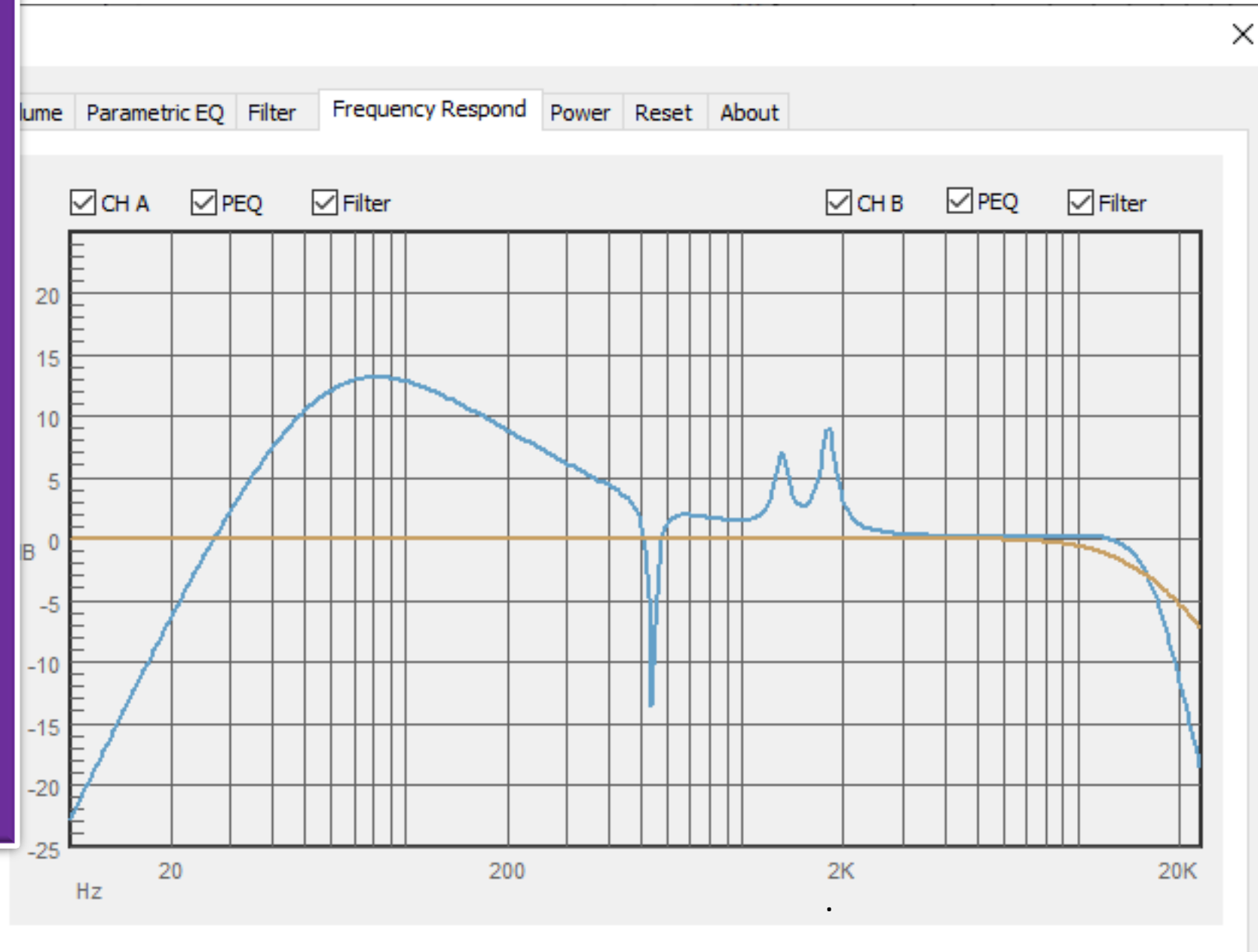

- Shows PoE connections **status**
- Provides setting for power limiter to **keep system stable**
- Selects the mode for **stereo or bridge** to mono and speaker parameters

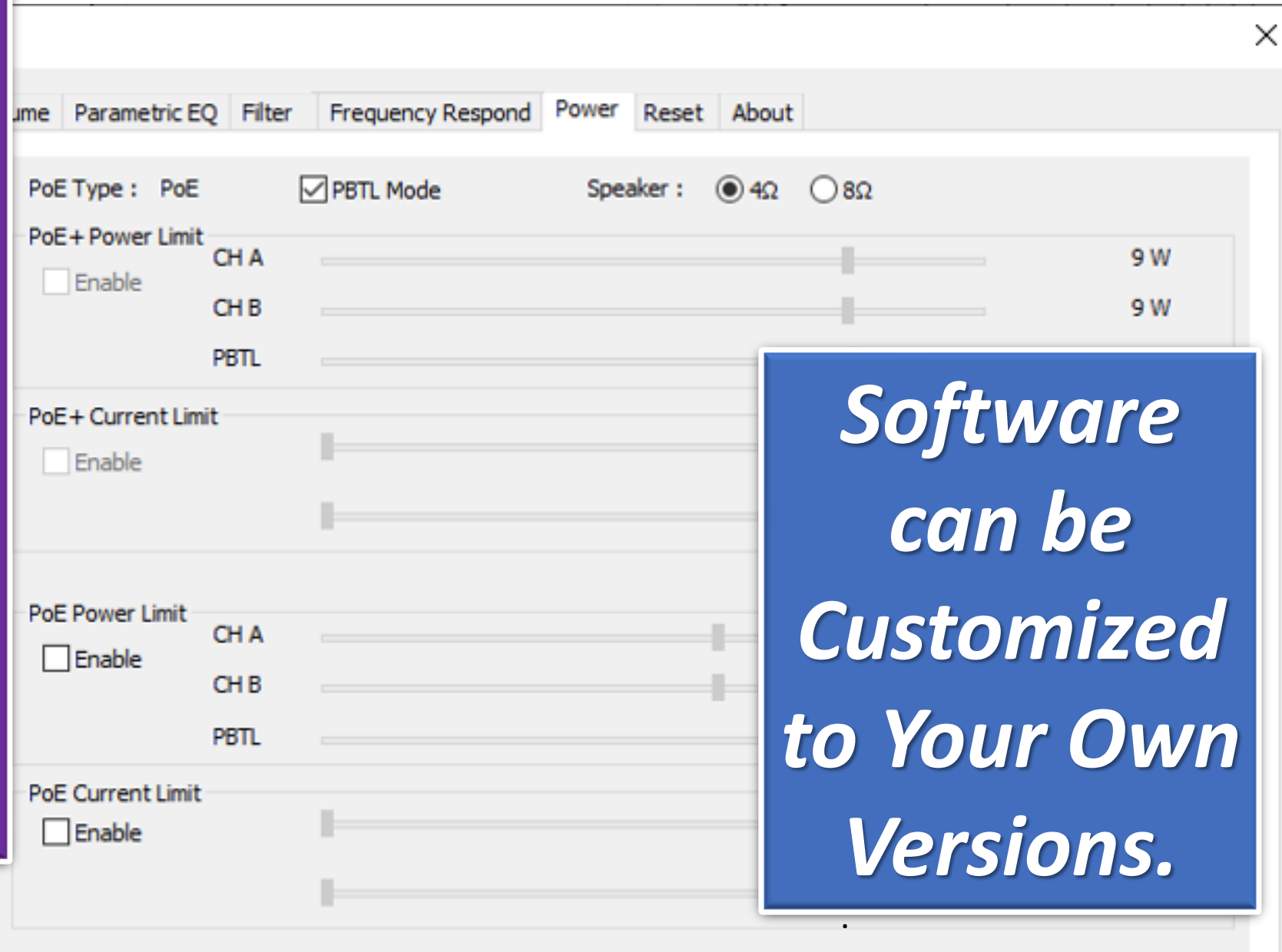

*Software
can be
Customized
to Your Own
Versions.*

The background of the image shows a server rack with numerous horizontal cables. Each cable is secured with a red plastic cable tie. The cables are arranged in neat rows, creating a sense of depth and order. The lighting is soft, highlighting the texture of the cables and the vibrant red of the ties.

Our **PoE** Amps
and Software
are **Ready** for
your brands **Now!**

WE LOVE TO

JDM / ODM / OEM

YOUR PRODUCTS

**HIGH QUALITY
PRODUCTION FACILITIES
IN TAIWAN and CHINA**

Keiga

Custom Installation S models

PRODUCT: [] Personal Custom Installation

DESCRIPTION: [] Switch-mode Power Supply [] Multichannel Class-D Amplifiers

TYPE: ☐ Design only ☐ JDM ☒ ODM ☐ OEM

KEIGA'S CONTRIBUTIONS IN DESIGN & DEVELOPMENT

CD Concept Design ☒ ID ☒ EE ☒ ME ☐ SE ☒ Features ☐ GUI

EE Electronic and Electrical Engineering ☐ AC Power Unit ☐ DC Power Unit ☒ AC/DC Power Unit ☒ Select Key Components ☒ I/O ☒ PCBA Circuitry ☐ Customized Layout ☐ RF ☐ Bluetooth ☐ Infrared ☐ Wi-Fi ☐ DECT ☐ UART ☐ USB ☐ I2C ☐ RS-232

ME Mechanical and Heat Engineering ☒ Chassis ☒ Industry Design ☒ Cables & Wires ☒ Connectors ☒ Heat Dissipation ☒ Tooling ☒ Metal ☒ Plastic ☒ Packaging ☒ User Manual

SE Software & Firmware Engineering ☐ GUI ☐ System ☐ DSP ☒ Firmware

CE Compliance and Certification Engineering ☐ EMI ☒ FCC/IC ☒ CE ☐ UL ☒ ETL ☒ RoHS

PE Purchasing & Production Engineering ☒ Key Component Purchasing ☒ Long Lead-Time Component Purchasing ☒ Engineering Sample ☒ Engineering Transfer

THANK YOU!

PLEASE CONTACT US FOR THE
PDF DOWNLOAD OF THIS
PRESENTATION.



US Office:

Mal Hollombe

US Advisor
Mal@Keiga.com.tw

Taiwan Office:

Jackson Chien

Deputy GM
jackson@keiga.com.tw

YF Tsai

PM Director
yftsai@keiga.com.tw

Demi Cheng

PM Specialist
demi@keiga.com.tw